



## AUSTRALIS RGB

Fully recessed Solid State colour change RGB LED downlight luminaires, based on the latest high power LED technology. Downlights are fitted with HL16 Red/Green/Blue LEDs and can be connected to a DMX compliant colour change driver. Australis RGB can provide a cost effective and versatile solution for a wide variety of exciting applications.

### FEATURES

- Fixed position recessed downlight housings available with a choice of attractive finishes
- Supplied with lamp retaining clip, adjustable suspension arms and fixed terminal block
- Extremely robust, resistant to vibration and illuminates instantly at temperatures as low as -10°C with reliable operation up to 40°C
- HL16 RGB LED light source with die cast heat sink assembly for optimal thermal management
- All luminaires supplied with retrofit sub-lenses to provide a choice of micro or wide beam angles
- Emits no UV or IR radiation and is therefore suitable for the illumination of sensitive materials or products
- Low heat, cool beam technology - safe to touch
- Up to 50,000 hours virtually maintenance free operation
- Remote mounted colour change DMX compliant driver available

### ORDER DETAILS

Order code	Description	Lamp Type and Rating
AURRGB	80mm DIA Fixed Position	3x350mA LED (RGB)

#### Suffix

PC	Polished Chrome Finish
PB	Polished Brass Finish
W	White Powder Coat Finish

#### Accessories

AUSTRALIS-RJ45CON	RJ45 connector assembly
AUSTRALIS-RJ45TP	RJ45 termination plug
AUSTRALIS-RJ45F	Molex to female RJ45 connector

#### LED Drivers

See our LED Driver Compatibility tables for the complete set of driver options on the Australis RGB range.

[www.apollolighting.co.uk](http://www.apollolighting.co.uk)

### TECH DETAILS

**Gear** Remote Electronic Colour Change LED Drivers

**Lamp Type** High Power 3x1W LED



The output of high-power LEDs is constantly improving therefore the type of LED in this product may change slightly to reflect the best optimum performance offered by LED technology.

When using LED DMX drivers please refer to our lighting control pages for Manual dimming and Colourstyle DMX controllers, or contact our technical department for advice.

### DIMENSIONS

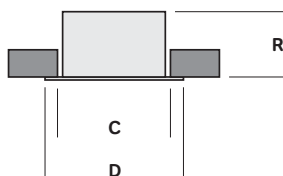

Dia	R	C (cut out)
80	80	65

### MATERIALS AND FINISHES

<b>Body</b>	Steel Bezel
<b>Controller</b>	Spot, or Wide Sub-lens
<b>Finish</b>	White, Brass or Chrome Plated

